



**BEIJING NUBWAY S&T CO., LTD**

ADD: Room 805, Yabao Road No.12, Chao yang District, Beijing, China

TEL: 86-10-51206522

FAX: 86-10-51206522

Website: [www.nubway.com](http://www.nubway.com)

---

## **Fractional Microneedle Machine NBW-FR200**

### **User Manual**



### **Content**

#### **Chapter 1 System Overview**

- 1.1 System introduction
- 1.2 Introduction to the treatment
- 1.3 Technical parameters

#### **Chapter 2 Safety**

- 2.1 Electrical and mechanical safety

2.2 Movement and transportation safety

### **Chapter 3 System Description**

3.1 Main structure

3.2 Components description

### **Chapter 4 Installation & Commissioning**

4.1 Installation

4.2 Commissioning

### **Chapter 5 Treatment**

5.1 Nursing process and parameter settings

### **Chapter 6 Treatment Principle**

6.1 Treatment principle

### **Chapter 7 Contraindications**

7.1 SRF & MRF Cautions

7.2 Contraindications

### **Chapter 8 Maintenance And Troubleshooting**

8.1 Cleaning the unit

8.2 Cleaning the treatment head

8.3 Replace the fuse wire

### **Chapter 9 Contact us**

Thanks for your purchasing Nubway Fractional RF Microneedle machine ! Believe that the machine can offer you a reliable function and satisfied experience.

**Note: The person operating or keeping it must read this manual carefully before using.**

## **Chapter 1 System Overview**

### **1.1 System Introduction**

※ System name: Fractional rf microneedle machine. It is used for whole body skin tightening, skin rejuvenation, skin lifting, wrinkle removal, anti-aging etc.

※ The machine is controlled by a computer, mainly composed by a host, a touch screen, one microneedle rf handle and one FRF treatment handle.

※ Operating and control parts of the machine are located in the mainframe, the built-in integrated micro-controller continuously monitors the operation of the equipment.

※ The control system includes touch screen, key switch and emergency stop

switches.

※ Screen can display and control system operating modes and parameters.

## 1.2 Introduction to the treatment

Unwanted hair removal for whole body:

- A pore, scar and acne removal
- B deep wrinkles removal
- C pigmentation removal
- D skin smooth
- E anti aging

## 1.3 Technical parameters

RF Frequency	5Mhz
RF Output	80W
Work mode	MFR ,SFR
MFR Needle depth	0~3 mm adjustable
MFR Pulse Time	100ms~600ms adjustable
MFR Delay Time	1~10 ms
SFR Pulse Time	1000ms~3000ms adjustable
RF Energy intensity	1~10 level
Invasive head area(cm2)	1*1 , 1.5*1.5 , 2*2
Electrode number	25pin ,49 pin ,81 pin
Led	650nm / 5mWX1
Noninvasive head	36 pin / 2*2 cm2
Input Voltage	110/220V; 50/60Hz
Dimention(cm)	44*46*160
Net Weight	30 kg

## Chapter 2 Safety

### 2.1 Electrical and mechanical safety

To ensure safety, the instrument designed and manufactured strictly implement GB: "General requirements for safety of medical electrical equipment" for the production and testing.

The operating system uses a single-phase 220V or 110V power supply, the maximum input current less than 10A.

In order to strengthen the life of the machine to reduce the impact of power

fluctuations on the machine, the user must use 2500W regulator.

Dangerous voltage presents inside the console during course of the treatment. After turning off the system, dangerous voltage still left. Removing the covers creates a safety hazard.

## **2.2 Movement and transportation safety**

The unit contains delicate components and no allowance of long transportation after first installation and adjustment. During the movement, the shock-absorbing package originated from the manufacturer must be used. Otherwise it might cause adverse effect to the system.

# **Chapter 3 System Description**

## **3.1 Main Structure**

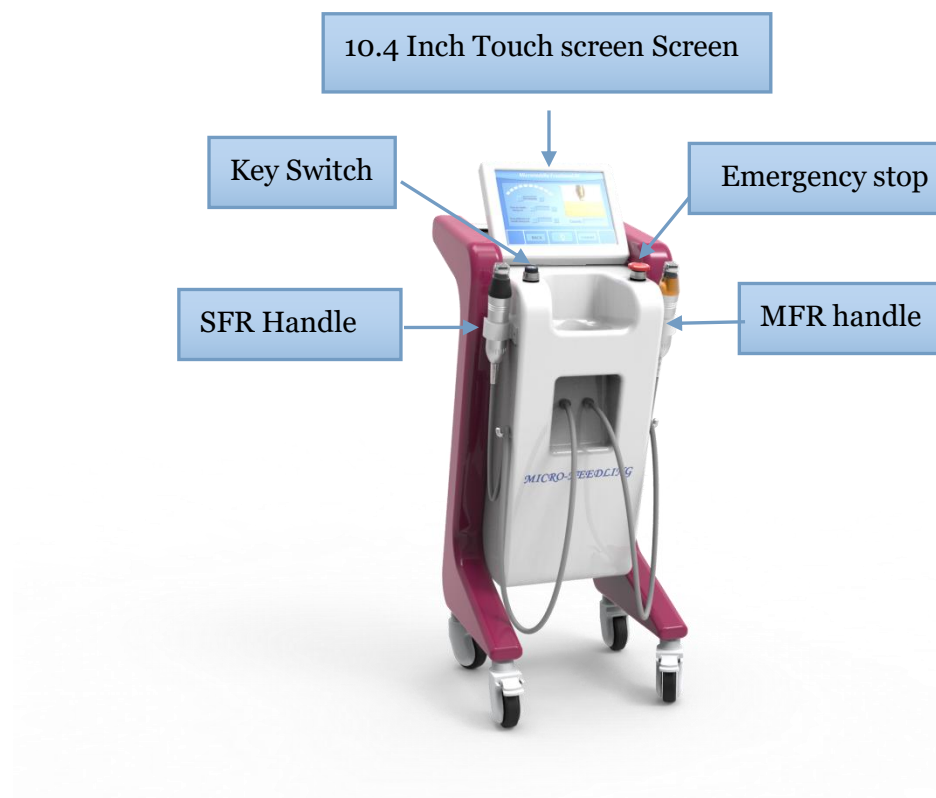

## **3.2 Component Description**

Touch screen: show and adjust the parameters of operation system

Emergency stop: Cut off the power source in emergency conditions

Main engine: cooling system, power supply, controlling system, integrated circuit

etc.

Treatment handles: removable type treatment handle.

Power line connection: connecting the power line

Leakage protector: safety for the machine

Key switch: turn on or turn off the machine

## Chapter 4 Installation & Commissioning

### 4.1 Installation

#### 4.1.1 First, check the accessories bag

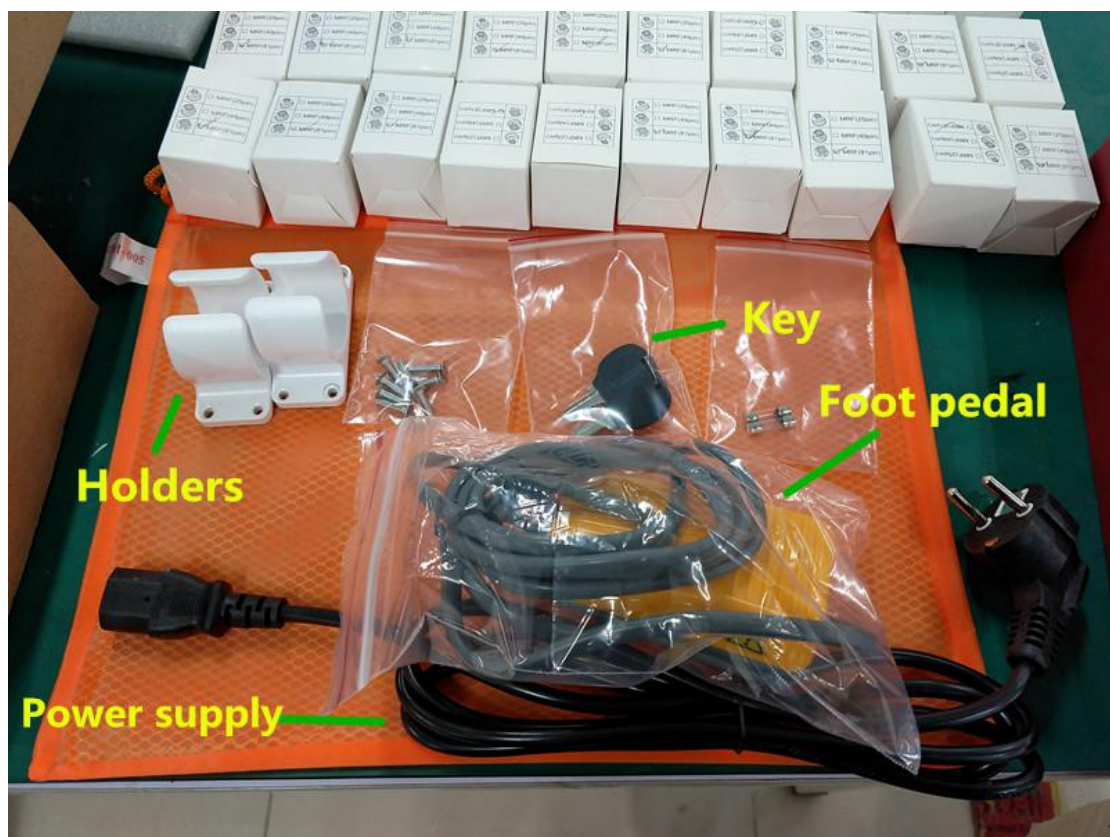

MRF Handle (invasive microneedle): 1 piece

SFR Handle (non-invasive fractional rf): 1 piece

Handle holders: 2 pieces

Switch key: 2 pieces

Foot switch: 1 piece

Power cord: 1 piece

Microneedle head 25 pins: 2 pieces

Microneedle head 49 pins: 2 pieces

Microneedle head 81 pins: 2 pieces

Fractional RF head: 1 pieces

Spare fuse: 2 pieces

USB flash (video and manual): 1 piece

**4.1.2** Insert the 2 holders (white color )into the side of the machine, fixing it with the screws. Then put the handles on the holders.

**4.1.3** Connect the 2 handles to the main body.

**4.1.4** Connect foot switch and power line, insert the switch key

## **4.2 Commissioning**

Make sure the red emergency stop is upward bounce. Turn right the key clockwise to start the system, then the system starts to work. The touch play screen shows as following (picture 1):



After loading auto to interface of pic-2. Choose the handle needed.

Handle 1 (Non-Invasive Thermage head) or Handle 2 (Invasive needle head)

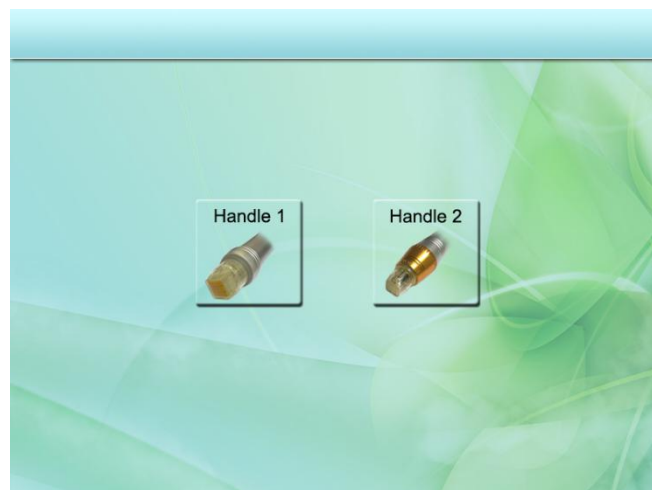

The system into the Handle 1 (SFR) operating interface: pic-3

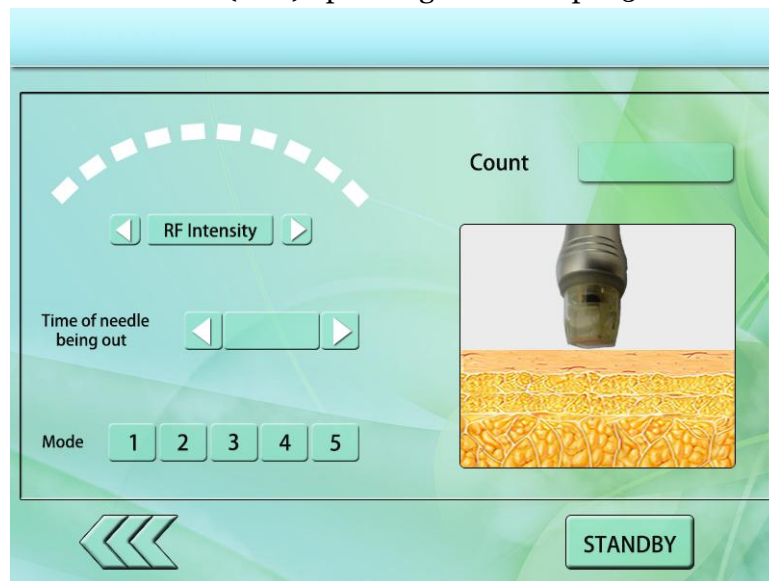

pic-3



is RF energy, range from 1-10, it is suggested to start the treatment from 2, and increase 1 by 1 until clients feel warm.



means the time that RF output, range from 1000ms to 3000ms.



5 different modes offered, you could preset RF Intensity and time of needle being out and save the parameters for the next treatment, very convenient.



After parameters setting, you could press to start treatment.

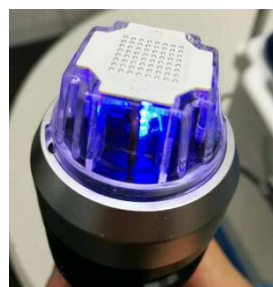



Notice: It is suggested to apply some castor oil to enhance the treatment results. Then closely touch the skin and move slowly.

Click  back to the handle choose page, the system into Handle 2 ( MRF ) operating interface: pic-4



pic-4

Choose the different size of needles according to the treatment area, then goes into interface: pic-5

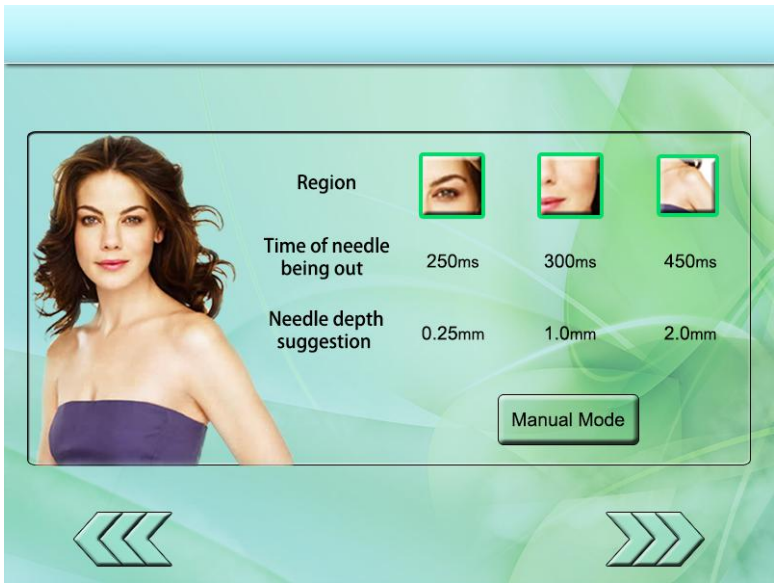



pic-5

Here we offered some suggested parameters according to the treatment areas, also

you could choose **Manual Mode** to set according to your needs. As shown in pic-6.

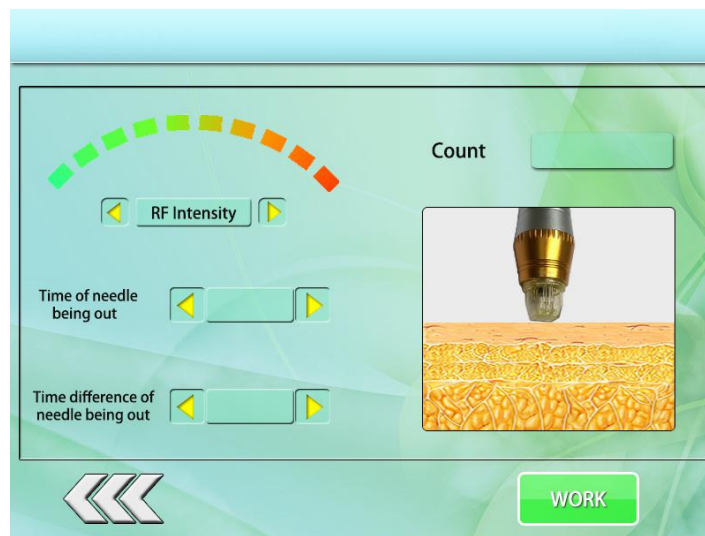

pic-6

Before adjusting RF energy, please rotate the rotary knob on the handle, to adjust the length of pins, range from 0.25-3mm, according to the depth of the wrinkle and skin conditions. Deeper the wrinkles, longer the length of pins.





is RF energy, range from 1-10. It is suggested to start the treatment from 2, and increase 1 by 1 until clients feel warm and a little pain.



means the time that RF output, range from 250ms to 600ms.



means the time difference between the needle into the skin and RF output, range from 1ms to 10ms. So that the energy will be totally absorbed by the deeper skin tissues and get better results.



After parameters setting, you could press to start treatment.



You could use squared paper for more convenient treatment. Please notice that it is not suggested to use anesthetic unless that clients can not stand the pain.

## Chapter 5 Treatment

### 5.1 Nursing process and parameter settings

#### Micro needle treatment

1. Deep clean the treated areas.
2. If needed (according to clients' feeling), apply the anesthetic
3. Choose appropriate working handles and treatment heads.
4. Depending on treatment areas, adjust the length of the pins.

0.25 / 0.5 is suitable for eye surroundings

1.0 / 1.5 / 2.0 is suitable for face

2.0 / 2.5 / 3.0 is suitable for body

5. Set RF intensity suggested from 2
6. Select “ time of needles being out ”

250ms to 300ms is suitable for eye surroundings

300ms to 450ms is suitable for face

450mm to 600ms is suitable for body

7. Select “time difference between needle being out”.
8. When the treatment finished, please use some ice to cool the skin and relieve the pain.

CAUTION: during face and body treatment, when the length of pins arrives 2.0mm or above, or intensity arrives 7 or above, it is recommended that only do one treatment in the same area. Do not repeat the treatment.

## **Chapter 6 Treatment Principle**

### **6.1 Treatment principle**

#### **(1) Microneedle Fractional Radio Frequency**

The MFR (Microneedle Fractional Radio Frequency) handpiece creates precise and controllable coagulation zones deep within the dermis; with 3-dimensional delivery of energy, maximizes skin volumization, provides dramatic skin tightening and skin rejuvenation, and offers a more comfortable procedure thanks to our flow needling technology. Depth control allows for customized treatments for delicate areas, such as the forehead and cheek bones and can deliver multiple passes. The microneedles deliver the RF energy precisely, so there is virtually no thermal damage to the epidermis, as a result MFR effectively lowers the risk of PIH in dark skin types.

#### **(2) Superficial Fractional Radio Frequency**

The SFR (Superficial Fractional Radio Frequency) handpiece provides minimally invasive delivery of RF energy to the epidermis and dermis with its unique dual

channel delivery system. The first channel delivers a deeper zone of controlled thermal effect, while the second channel provides micro ablation of the upper layers of the epidermis and mild coagulation. Working in combination, the two distinctive channels result in luminous skin, controlled tightening and scar revision.

## **Chapter 7 Contraindications**

### **7.1 Handle 1 & Handle 2 Cautions**

1. When insert heads into the handles, please confirm whether fully inserted.
2. During the treatment, customers are not allowed to wear metal decorations.
3. If use SRF head, it is suggested to use some castor oil.
4. When apply gel or other cream in the SRF treatment, high energy (high temperature) may cause smoke, please clean it immediately.

### **7.2 Contraindications**

#### **Forbidden Group**



1. People with heart disease or high blood pressure, or configured cardiac pacemaker.
2. Patients with acute inflammation, asthma, deep vein thrombosis, thyroncus, cancer.
3. People with hemorrhagic disease, trauma or who is bleeding.
4. Pregnant women
5. Medical Plastic parts, or parts with artificial in filling inside.
6. People with metal inside the body(include metallic tooth)
7. Patient with skin inflammation or with edema.
8. People with an abnormal immune system.
9. Numb or insensitive to heat.

## **Chapter 8 Maintenance And Troubleshooting**

### **8.1 Cleaning the unit**

Clean the system exterior at least once a week. Wipe all surfaces with soft, damp, non-abrasive cloth. Mild cleansing solution may be used. Not spill liquids in the unit.

### **8.2 Cleaning the treatment head**

Clean the SRF handle after each treatment. One needle one person, and the same needle can be used many times for the same person, alcohol is needed for each treatment.

### 8.3 Replace the fuse wire

Turn off all power switch, unplug the power cord; open the fuse holder with a small flat-head screwdriver, and then take the fuse wire in the fuse holder. Take out the spare (15A / 250V) fuse wire in the accessories sent to you along with the machine.

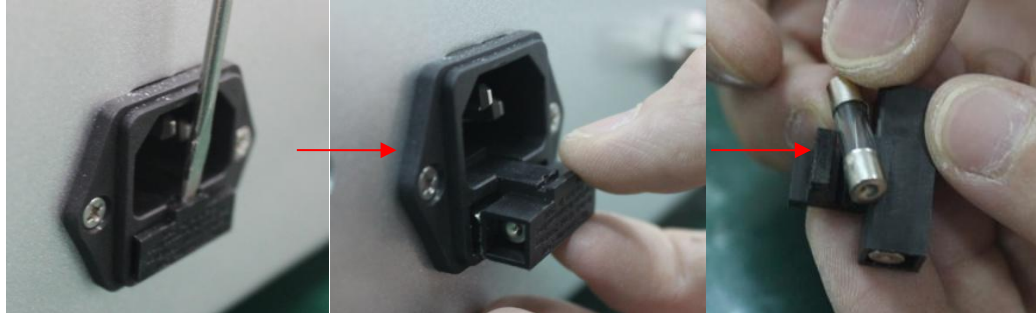

1

2

3

## Chapter 9 Contact us

Beijing Nubway S&T Co.,Ltd

Web: [www.nubway.net](http://www.nubway.net)

Email: [harry@nubwaycompany.com](mailto:harry@nubwaycompany.com)/[harrynubway@gmail.com](mailto:harrynubway@gmail.com)

Tel: 0086 10 60418533

Fax: 0086 10 60418533

Add: Building No.5, Mauhwa Industry Park, Caida 3rd Street 1, Shunyi District,  
Beijing 101300 China.